



MOBILITY



MODULARITY



FAST SET-UP



CUSTOMIZATION



## ASPHALT MIXING PLANT CSD 1510



EXPERTS IN ASPHALT & CONCRETE PLANTS

# CONFIGURATION EXAMPLES



## A Basic plant

Cold feeding unit with 4 bins  
 Screening and drying drum  
 Filter  
 Hot bins and reclaimed filler silo  
 Mixer  
 Pump room 20'  
 Control cabin 20'



## B Plant with optional equipment

Cold feeding unit with 4 bins  
 Screening and drying drum  
 Filter  
 Hot bins and reclaimed filler silo  
 Mixer  
 Pump room 40'  
 Control cabin 20'  
 External filler silo  
 External hot storage silo - 100 t  
 Bitumen tanks  
 Bitumen filling station  
 Light oil tank



## C Plant with integrated hot storage silo

Cold feeding unit with 4 bins  
 Screening and drying drum  
 Filter  
 Hot bins & reclaimed filler silo  
 Mixer  
 Integrated hot storage silo 60 t  
 Pump room 40'  
 Control cabin 20'  
 External filler silo

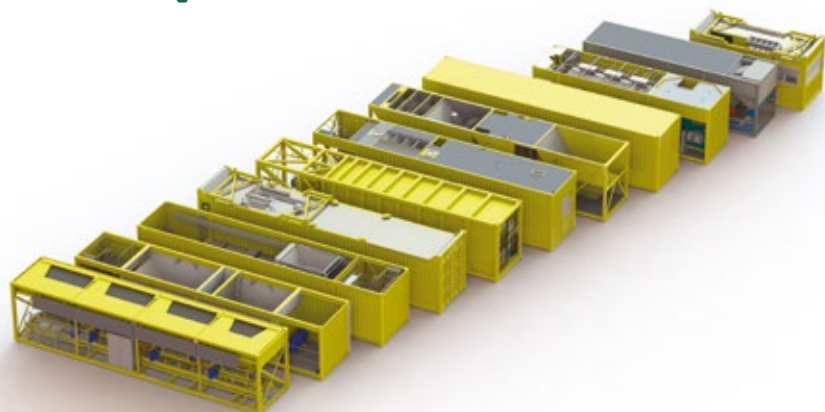

Transport volume of configuration C

Container	Qty
40' HC	6
40' DC	2
30' HC	2
20' HC	1
<b>total</b>	<b>11</b>





# MAIN PLANT COMPONENTS

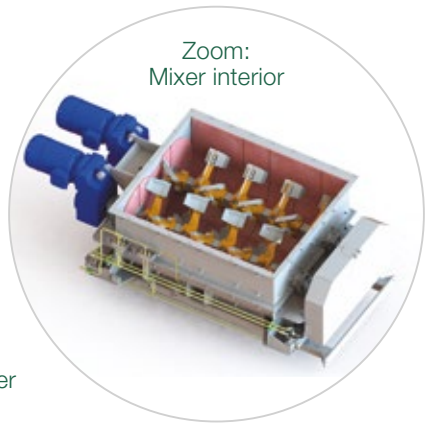
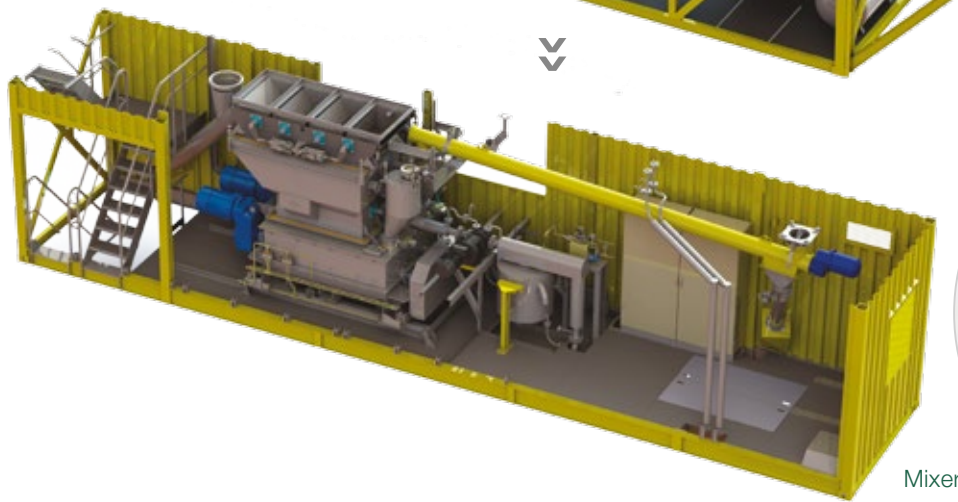
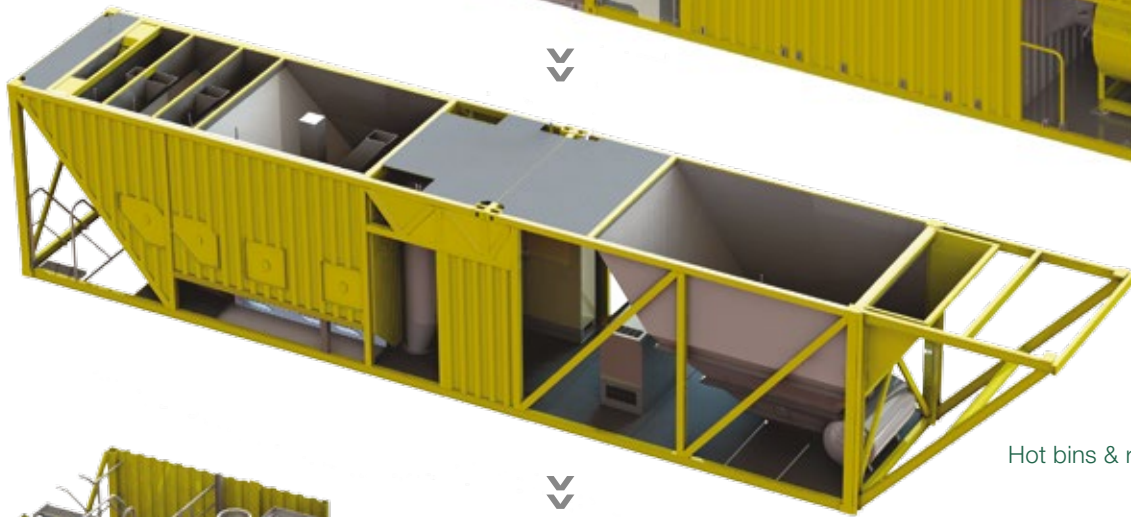
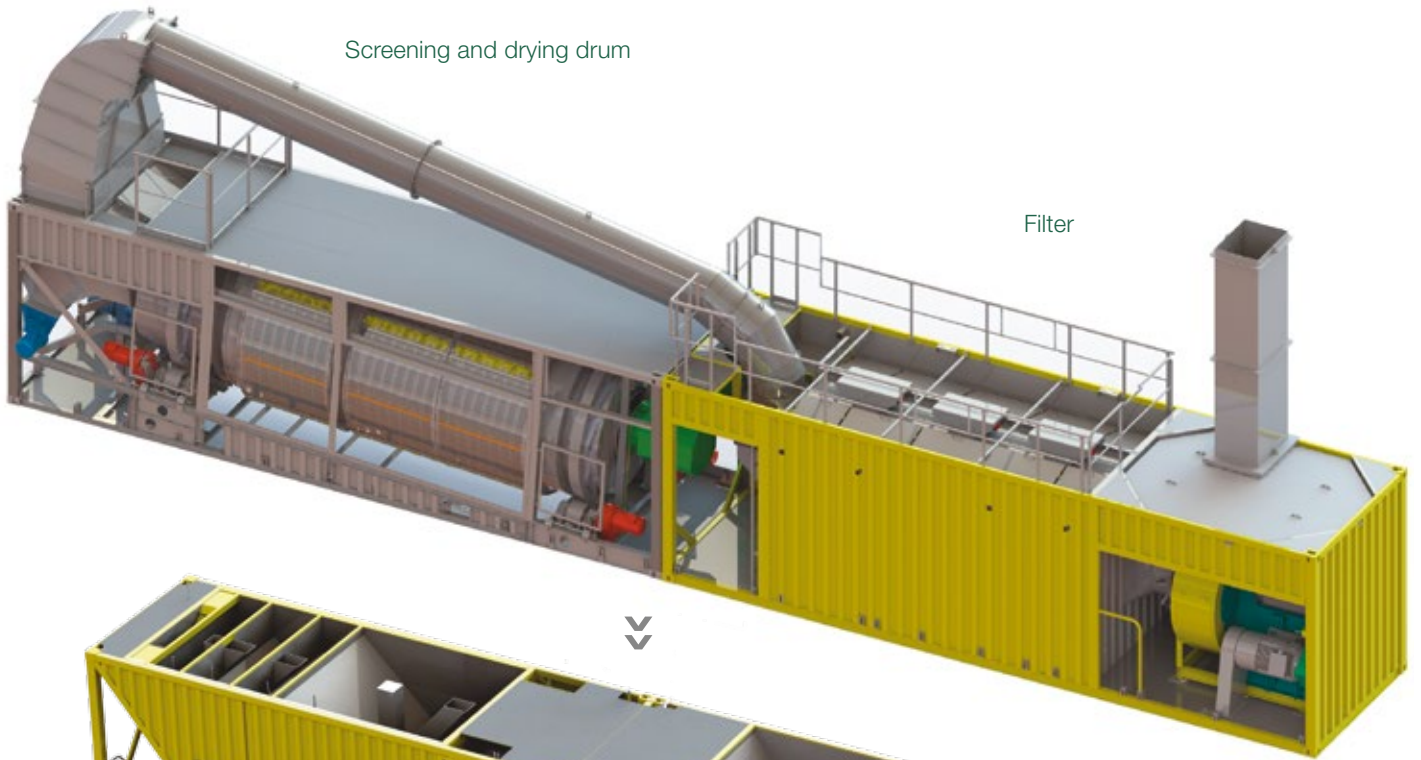





Technical description	Unit	CSD1510
Plant capacity	t/h	120
Batch size	kg	1650
Batch cycle time	s	45
Screen decks	pcs.	4
Hot stone bin	t	25
Reclaimed filler silo	t	15
Aggregate temperature increase	K	150
Exhaust gas temperature	°C	90-120
Burner capacity	MW	8

#### Optional equipment

- Tanks for bitumen and light oil
- External filler silos
- Hot storage silos – external and integrated
- Additive systems for fiber and liquid additives
- Recycling systems for cold and hot recycling
- Prepared for LINTEC Warm Mix Asphalt System LEP

#### LINTEC BURNER TECHNOLOGY

Optimum combustion air technology with dual fuel head  
 Single fuel or combinations: Light oil | heavy oil | gas

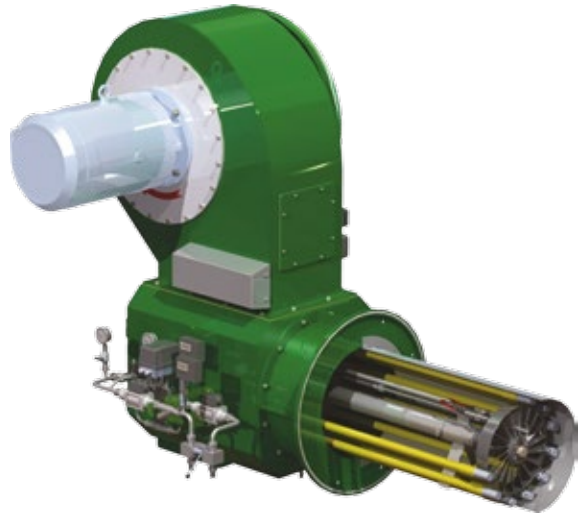

**LINTEC GmbH & Co. KG**  
 Alter Postweg 28  
 21614 Buxtehude  
 Germany



Tel. +49 4161-866-0  
 Fax +49 4161-866-188  
 Email [info@lintec-gmbh.de](mailto:info@lintec-gmbh.de)  
[www.lintec-gmbh.de](http://www.lintec-gmbh.de)

Subject to technical modifications –  
 errors and omissions excepted.